

LEAVEY
EXECUTIVE
CENTER
SANTA CLARA UNIVERSITY

CERTIFIED
EQUITY
PROFESSIONAL
INSTITUTE

naspp
National Association of
Stock Plan Professionals

CEPI & NASPP SYMPOSIUM

JOIN US FOR OUR MOST CONTENT-FILLED ONE-DAY
EVENT YET: OVER 25 SESSIONS TO CHOOSE FROM!

**JULY 21,
2026**

SANTA CLARA UNIVERSITY
LEAVEY SCHOOL OF BUSINESS
LUCAS HALL

ABOUT US

CERTIFIED EQUITY PROFESSIONAL INSTITUTE (CEPI)

NATIONAL ASSOCIATION OF STOCK PLAN PROFESSIONALS (NASPP)

The CEPI at the Leavey Executive Center is the premier certification body for equity compensation professionals. Offering certification, research, and continuing education, the CEPI is well positioned in the equity compensation industry and has a proven track record of meeting and exceeding the needs of today's equity compensation professionals.

Founded in 1992, the NASPP provides education, resources, and a collaborative community for professionals involved in stock plan design, administration, and compliance. Together, the CEPI and NASPP support the ongoing growth and professionalism of the equity compensation field.

OUR VISION

By joining forces, the CEPI and the NASPP will provide meaningful insights and expertise that elevate and support the entire equity compensation community.

OUR MISSION

Together, NASPP and the CEPI are committed to delivering unmatched support, education, and resources to equity compensation professionals, helping them excel in their roles and advance the industry.

LEAVEY
EXECUTIVE
CENTER
SANTA CLARA UNIVERSITY

CERTIFIED
EQUITY
PROFESSIONAL
INSTITUTE

naspp
National Association of
Stock Plan Professionals

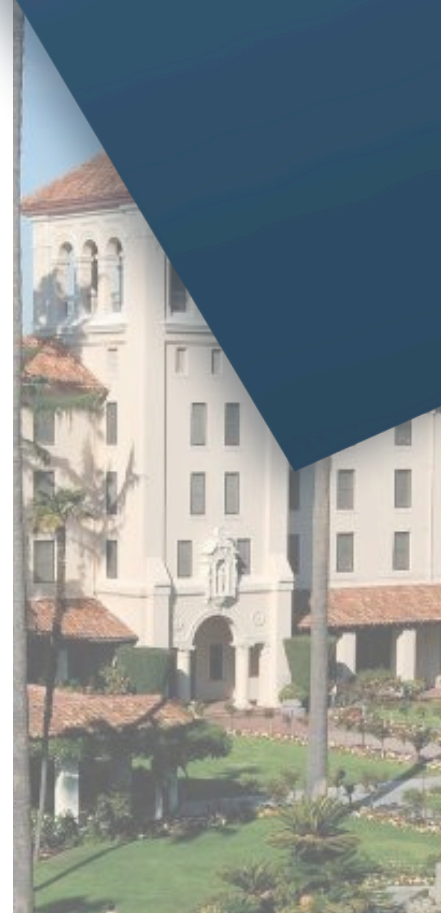

2026 CEPI & NASPP SYMPOSIUM

LOCATION

Lucas Hall in the Leavey School of Business at Santa Clara University in Santa Clara, California

LEAVEY
EXECUTIVE
CENTER
SANTA CLARA UNIVERSITY

CERTIFIED
EQUITY
PROFESSIONAL
INSTITUTE

naspp
National Association of
Stock Plan Professionals

CONTENT

Five expertly curated sessions with six tailored options per session, featuring more presentations and speakers than ever before. Gain practical, actionable insights designed to elevate your expertise and deliver immediate impact in your professional role.

FORMAT

Join us for our most dynamic event yet, a one-day, in-person experience at Santa Clara University featuring more session options than ever before. This premier gathering offers top-tier educational programming led by industry experts, alongside exceptional networking opportunities with professionals and peers. Immerse yourself in a day of impactful learning, meaningful connections, and continued growth with on-demand access to all recorded sessions after the event.

EXHIBITOR SPACE



1st Floor

■ Exhibitor Space

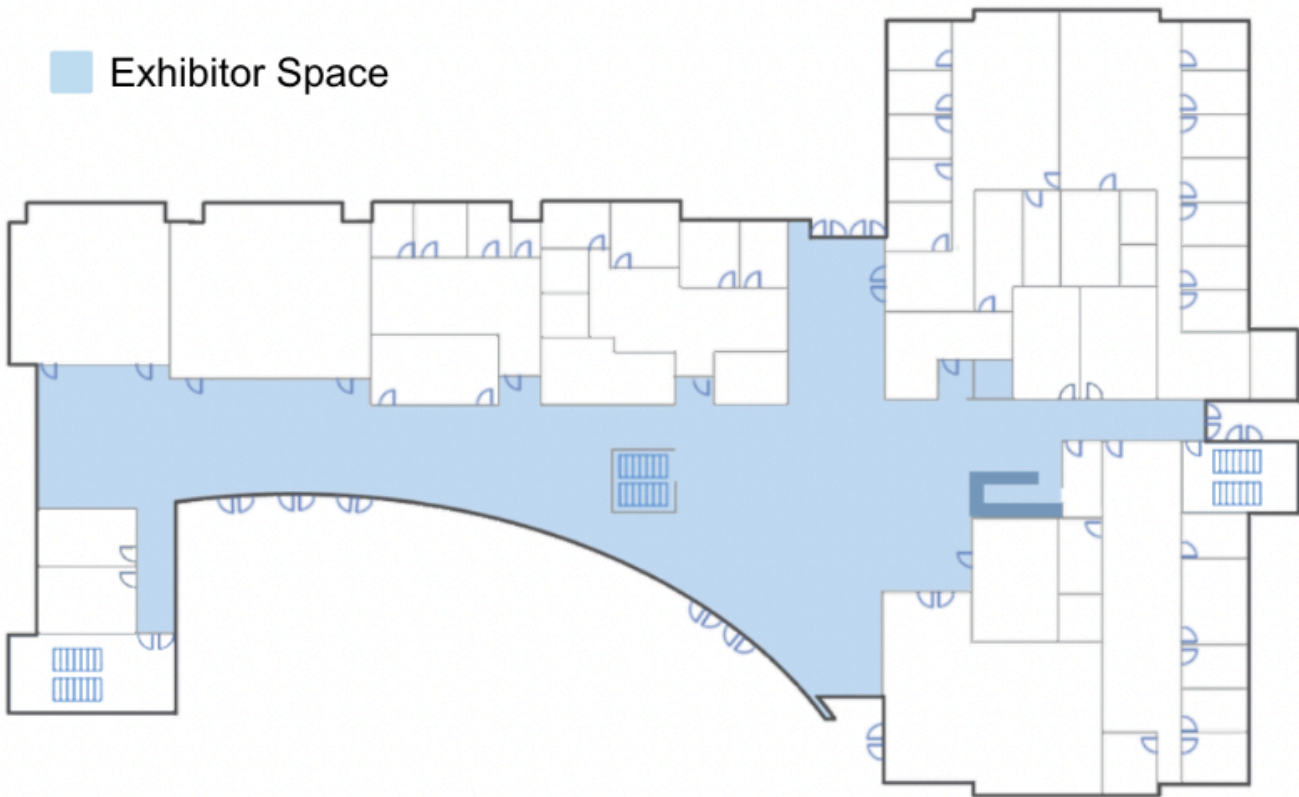

2026 SYMPOSIUM SPONSORSHIP PACKAGES

Option to host a private event before or after the Symposium.

PAVILION LEVEL \$8,000

Premium visibility as a featured sponsor. Access to the attendee registration list for one-time email outreach.

- 10 full-access Symposium passes for client attendees
 - Passes not used on-site? Redeem them for the Virtual Symposium!
- 3 limited-access passes for sponsor representatives (exhibitor only)
- Prominent recognition in Symposium communications and CEPI website
- Large logo displayed on the sponsor page
- 8' exhibitor table for onsite interaction

EXHIBITOR LEVEL \$4,000

A popular choice for impactful event presence. Access to the attendee registration list for one-time email outreach.

- 5 full-access Symposium passes for client attendees
 - Passes not used on-site? Redeem them for the Virtual Symposium!
- 2 limited-access passes for sponsor representatives (exhibitor only)
- Recognition in Symposium communications and on the CEPI website
- Medium logo featured on the sponsor page
- 8' exhibitor table for onsite engagement

SUPPORTER LEVEL \$1,000

Tailored for organizations seeking an affordable opportunity to showcase their brand while maintaining a presence at the event.

- Economical way to support the event
- Includes 2 full-access Symposium passes for sponsor representatives
- Acknowledgment in Symposium communications and on the CEPI website
- Small logo featured on the Symposium sponsor page

VENDORS MAY PROVIDE A BRANDED TABLECLOTH TO FIT AN 8-FOOT TABLE, ALONG WITH TABLETOP MATERIALS OR DISPLAYS, IF DESIRED. EXHIBITORS SHOULD PLAN FOR MATERIALS TO FIT ON THE PROVIDED TABLE OR ON A SMALL, UNPOWERED DISPLAY (LESS THAN 2 SQ. FT.) THAT CAN BE PLACED ALONGSIDE THE TABLE, IF APPLICABLE.

COMMITMENT DUE BY MAY 15

EMAIL CEPI@SCU.EDU WITH YOUR SPONSORSHIP LEVEL INTEREST

SPONSORSHIP	PAVILION: \$8,000	EXHIBITOR: \$4,000	SUPPORTER: \$1,000
LOGO ON SPONSORSHIP PAGE	LARGE	MEDIUM	SMALL
8 FOOT EXHIBITOR TABLE?	YES	YES	NO
ATTENDEE PASSES	10	5	2
EXHIBITOR PASSES	3	2	0
\$50 OFF ADDITIONAL ATTENDEE PASSES?	YES	YES	YES

Build meaningful industry relationships to foster collaboration and open doors to new opportunities. Increase brand recognition by showcasing your unique value and establishing a strong presence within your field. Expand your outreach to connect with a broader audience, strengthen your network, and create lasting impact.

**LEAVEY
EXECUTIVE
CENTER**
SANTA CLARA UNIVERSITY

**CERTIFIED
EQUITY
PROFESSIONAL
INSTITUTE**

naspp
National Association of
Stock Plan Professionals

CONTACT US



cepi@scu.edu



<https://www.scu.edu/execed/cepi/>

**WE LOOK
FORWARD TO YOUR
PARTICIPATION IN
THIS UNIQUE AND
MEMORABLE
EVENT!**